

# PBCG SERIES - Deep Cycle GEL

## PBCG12-100L(12V100Ah)

### Specification

Nominal Voltage	12V	
Nominal Capacity(20HR)	100.0Ah	
Dimensions	Length	329 ± 3mm
	Width	172 ± 2mm
	Container Height	215 ± 3mm
	Total Height (with Terminal)	240 ± 3mm
Approx Weight	Approx 30.6 kg	
Terminal	T11	
Container Material	ABS	
Rated Capacity	101.60 Ah/5.08A	(20hr, 1.80V/cell, 25°C)
	97.90 Ah/9.97A	(10hr, 1.75V/cell, 25°C)
	76.00 Ah/15.20A	(5hr, 1.75V/cell, 25°C)
	71.25 Ah/23.75A	(3hr, 1.75V/cell, 25°C)
	56.05Ah/56.05A	(1hr, 1.65V/cell, 25°C)
Max. Discharge Current	900A (5s)	
Internal Resistance	Approx 5.9mΩ	
Operating Temp. Range	Discharge	-20 ~ 55°C
	Charge	0 ~ 40°C
	Storage	-20 ~ 50°C
Nominal Operating Temp. Range	25 ± 3° C	
Cycle Use	Initial Charging Current less than 24.0A. Voltage	
	14.4V~15.0V at 25°C Temp. Coefficient -30mV/°C	
Standby Use	No limit on Initial Charging Current Voltage	
	13.5V~13.8V at 25°C Temp. Coefficient -20mV/°C	
Capacity affected by Temperature	40° C	103%
	25° C	100%
	0° C	86%
Self Discharge	PBCG series batteries may be stored for up to 9 months at 25° C and then a freshening charge is required. For higher temperatures the time interval will be shorter.	



### Applications

- ◆ Telecommunications
- ◆ Solar system
- ◆ Wind power system
- ◆ Wheelchair
- ◆ Floor cleaning machines
- ◆ Golf trolley
- ◆ Boats

Intertek



### Constant Current Discharge (Amperes) at 25 °C (77°F)

F.V/Time	20min	30min	45min	1h	2h	3h	4h	5h	6h	8h	10h	20h
1.85V/cell	90.25	72.20	55.10	44.65	28.50	21.85	18.05	14.25	12.35	10.45	9.03	4.88
1.80V/cell	107.35	84.55	59.85	50.35	30.40	22.80	19.00	14.73	13.30	11.78	9.50	5.08
1.75V/cell	115.90	88.35	63.35	52.25	31.35	23.75	19.95	15.20	13.78	12.35	9.79	5.29
1.70V/cell	121.60	92.15	67.45	54.15	32.30	24.70	20.71	16.15	14.25	13.78	10.17	5.49
1.65V/cell	128.25	95.00	70.30	55.05	34.20	25.65	21.38	17.10	14.73	14.25	10.55	5.69
1.60V/cell	133.00	99.75	73.15	57.95	36.10	26.60	22.33	18.05	15.68	15.20	10.93	5.90

### Constant Power Discharge (Watts/cell) at 25 °C (77°F)

F.V/Time	20min	30min	45min	1h	2h	3h	4h	5h	6h	8h	10h	20h
1.85V/cell	166.96	133.57	101.94	82.60	52.73	40.42	33.39	26.36	22.85	19.33	16.70	9.03
1.80V/cell	193.23	152.19	107.73	90.63	54.72	41.04	34.20	26.51	23.94	21.20	17.10	9.15
1.75V/cell	202.83	154.61	111.39	91.44	54.86	41.56	34.91	26.60	24.11	21.61	17.12	9.25
1.70V/cell	206.72	156.66	114.67	92.06	54.91	41.99	35.21	27.46	24.23	23.42	17.28	9.33
1.65V/cell	211.61	156.75	116.00	92.48	56.43	42.32	35.27	28.22	24.30	23.51	17.40	9.39
1.60V/cell	212.80	159.60	117.04	92.72	57.76	42.56	35.72	28.88	25.08	24.32	17.48	9.43

Disclaimer: Manufacturers have the right to self-modify the parameters of the updates without notice, please keep in touch with manufacturers to obtain the latest information.



# Dimensions

## T7 Terminal

Unit: mm

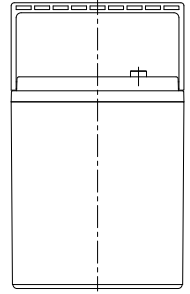
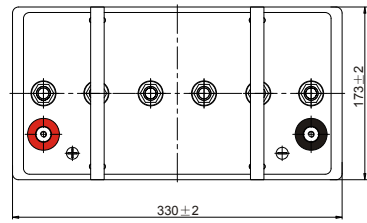
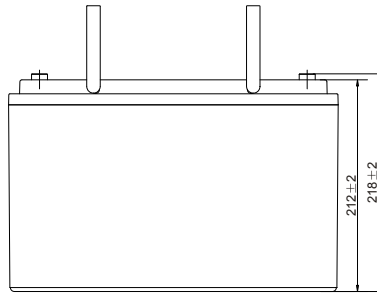
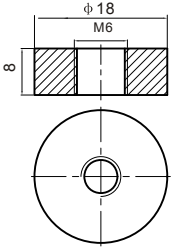

## Discharge Characteristics

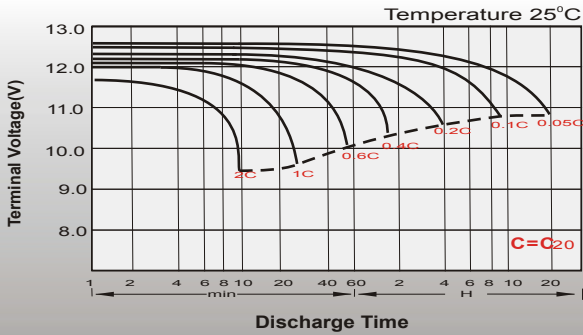

## Float Charging Characteristics

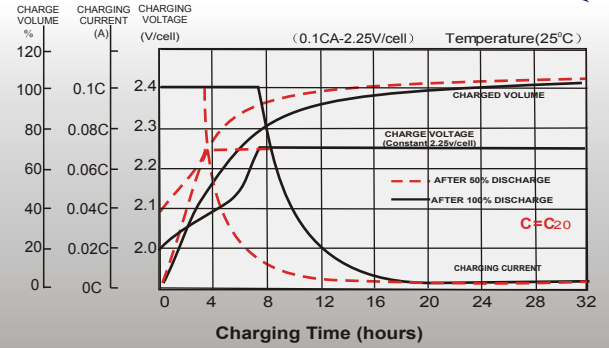

## Temperature Effects in Relation to Battery Capacity

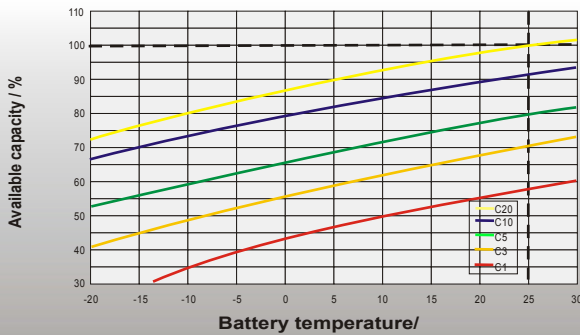

## Effect of Temperature on Long Term Float Life

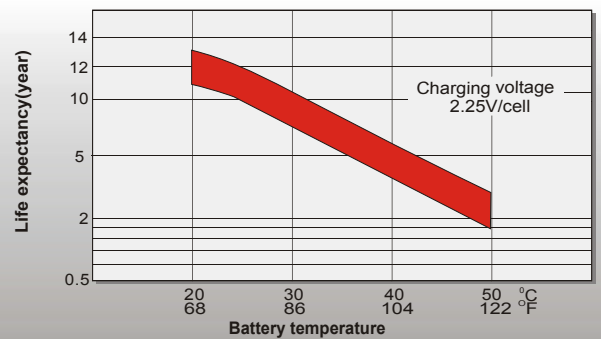

## Cycle Life in Relation to Depth of Discharge

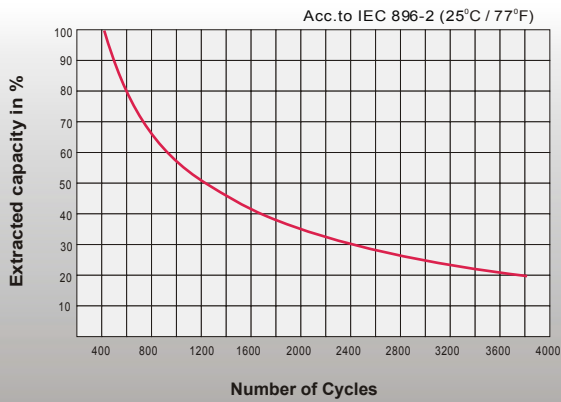

## General Relation of Capacity VS. Storage Time

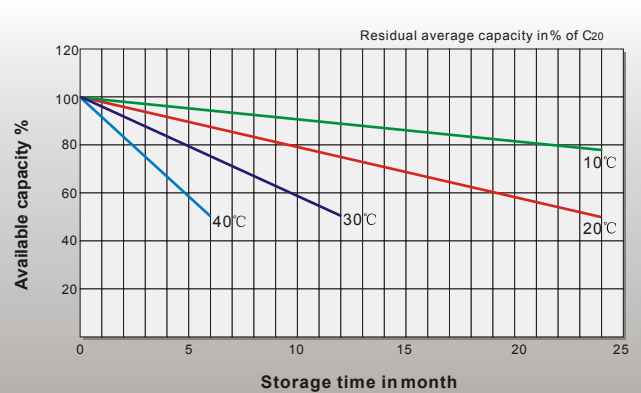

## Contact